

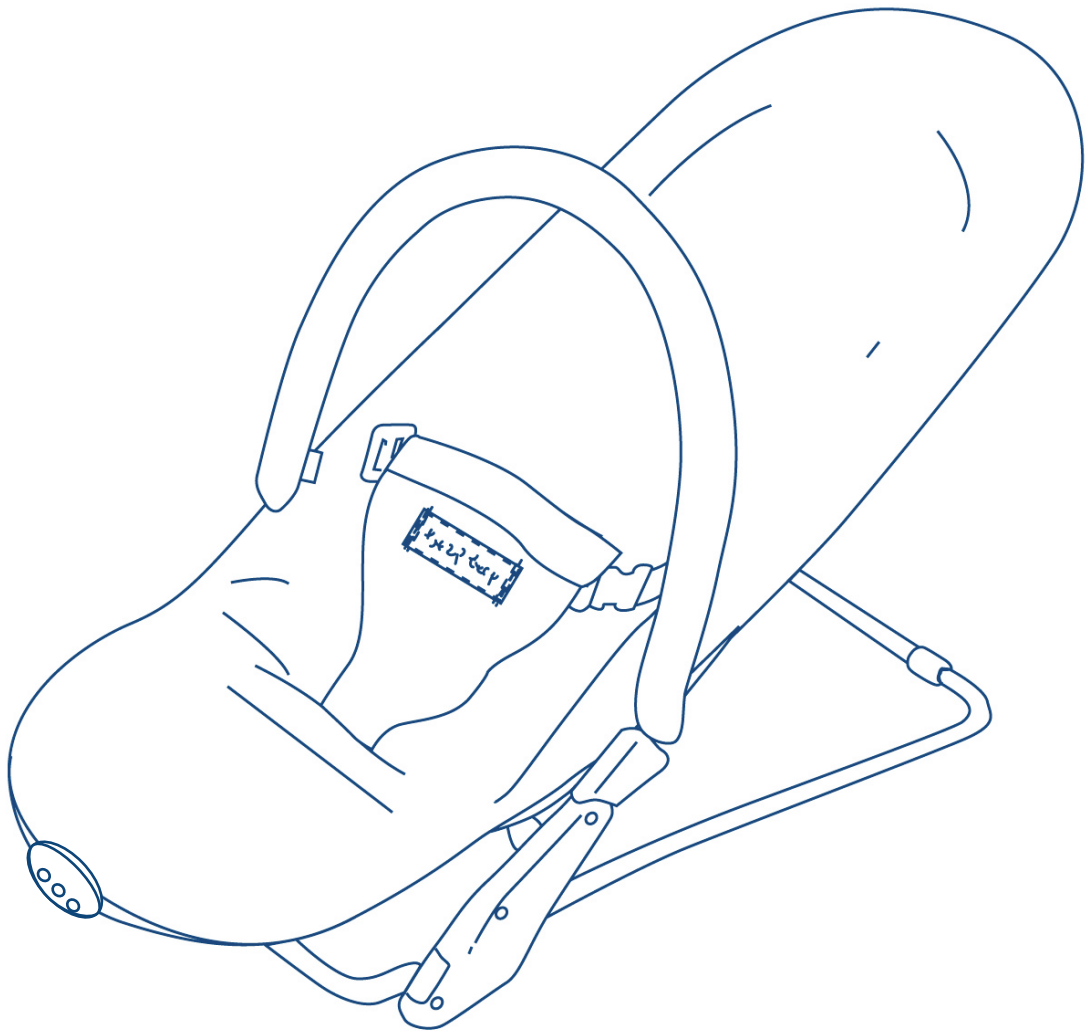

**bouncing cradle
with toys
user guide**



Important! Keep for future reference

introduction

Read these instructions carefully before use and keep them for future reference. Your child's safety may be affected if you do not follow these instructions.

This cradle is not recommended for babies who can sit up by themselves (6 months approximately; until 9 kg).

Do not attempt to lift the bouncing cradle by the toy bar. For your child's safety, the toy bar will detach if such an attempt is made.

parts checklist

fig 1a

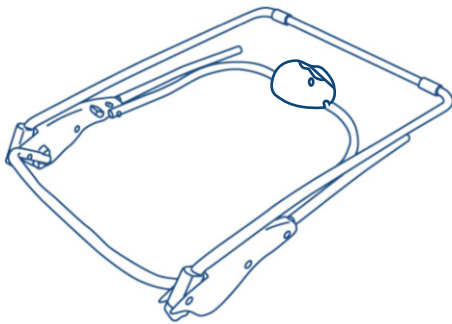

base frame

fig 1b

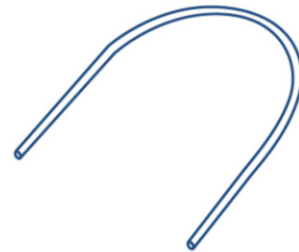

backrest frame

fig 1c



seat cover

fig 1d

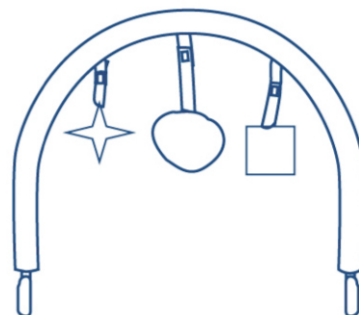

toybar & toys

preparation for use

installing the battery

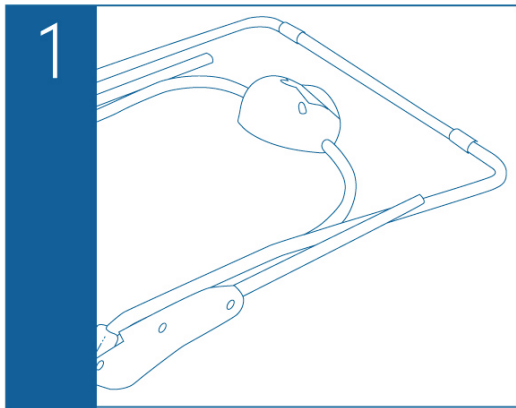

Make sure you have the base frame placed upside down on a firm surface so that the screw for the battery cover of the vibrating unit is clearly visible.

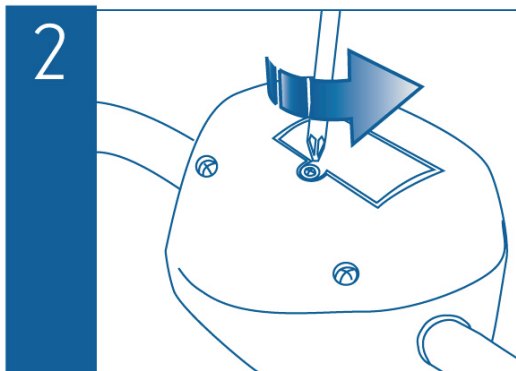

Using a Phillips screwdriver undo the battery cover on the vibrating unit.

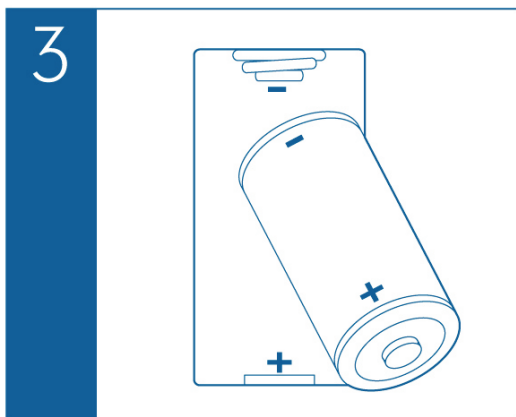

Insert one MN1400 (C, LR14) battery (not included) ensuring the negative end of the battery '-' is connected to the negative end of the battery compartment (also marked '-').

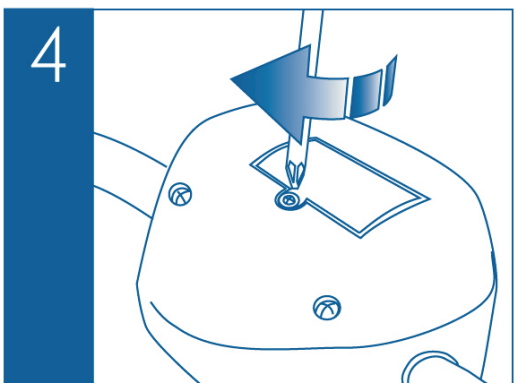

Close the cover and tighten the screw on the battery compartment.

preparation for use

fig 2

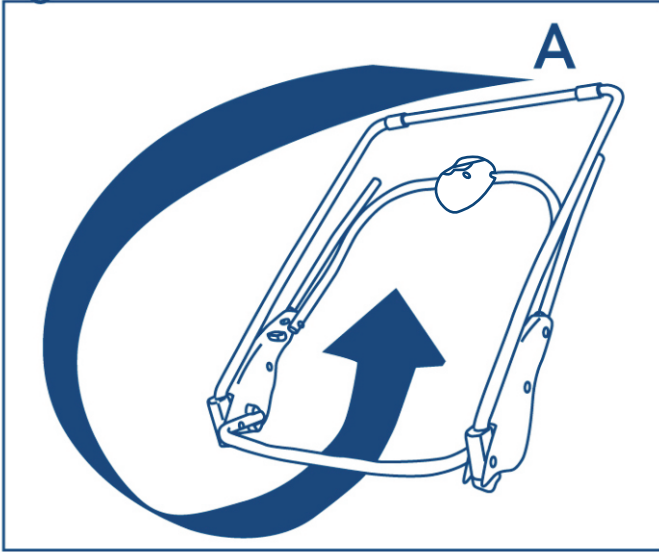

Pull bar (A) right around until it locks into place against the hinges. Next, lower the footrest frame.

fig 3

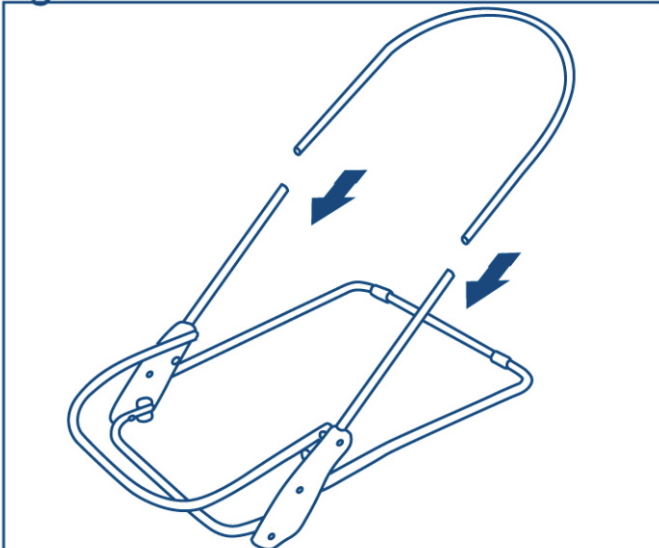

Place the frame on the floor with the open tubes pointing upwards. Insert the ends of the backrest frame into these open tubes. The retaining clips will 'click' through holes in the tubes when properly located.

fig 4

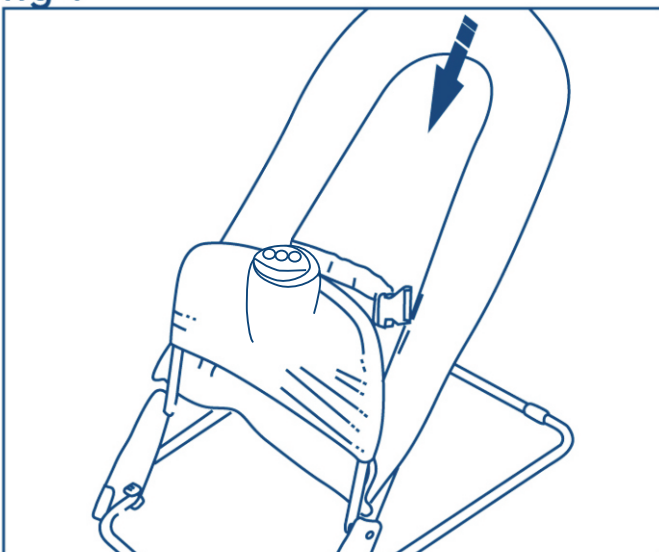

Lift the footrest frame to the upright position. The seat cover has two 'pockets'. Slide the larger of these over the backrest frame and the smaller pocket over the footrest frame and vibration unit.

preparation for use

fig 5

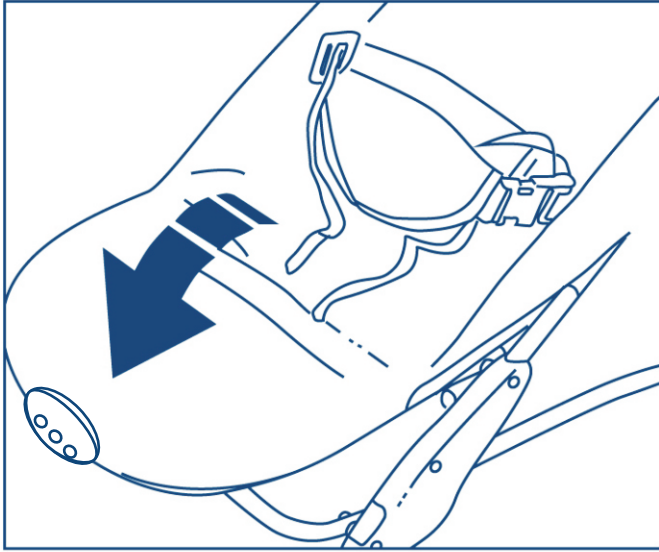

Press the footrest down towards the floor until it locks into place, holding the seat cover taut.

attaching the toybar

fig 6

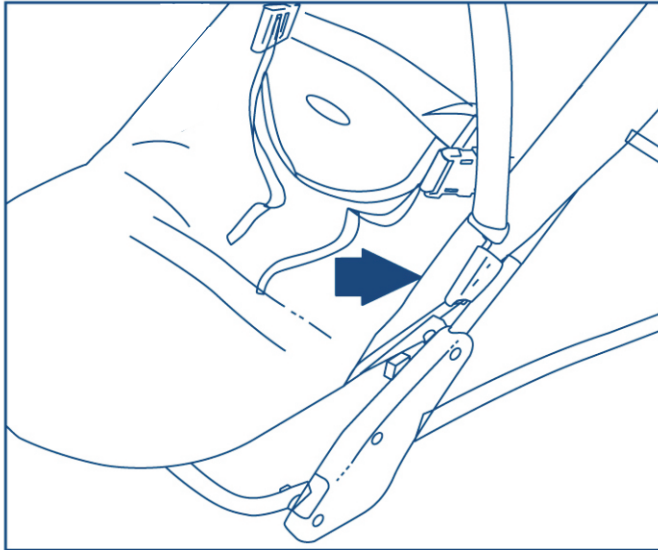

When attaching the toy bar to the bouncer ensure that the metal bar is at the top of the clips. Attach the toy bar to the frame just above the plastic hinges.

Note: the toy bar should never be used as a carrying handle.

fig 7

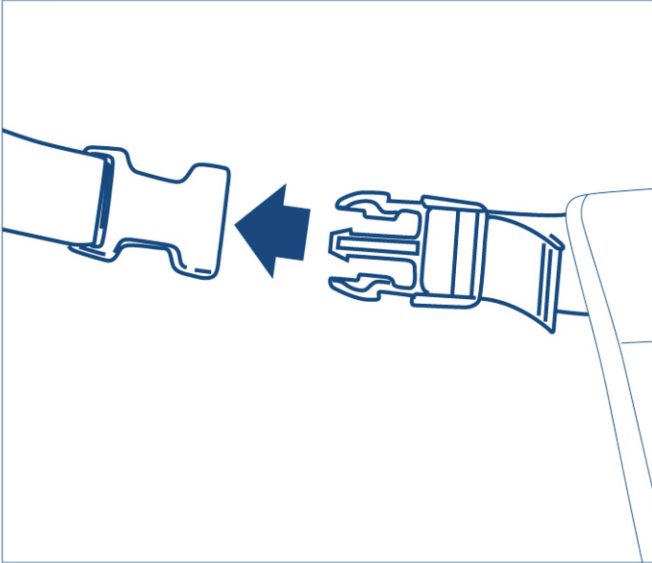

Pass the crotch strap between baby's legs, fastening the buckles as shown.

fig 8

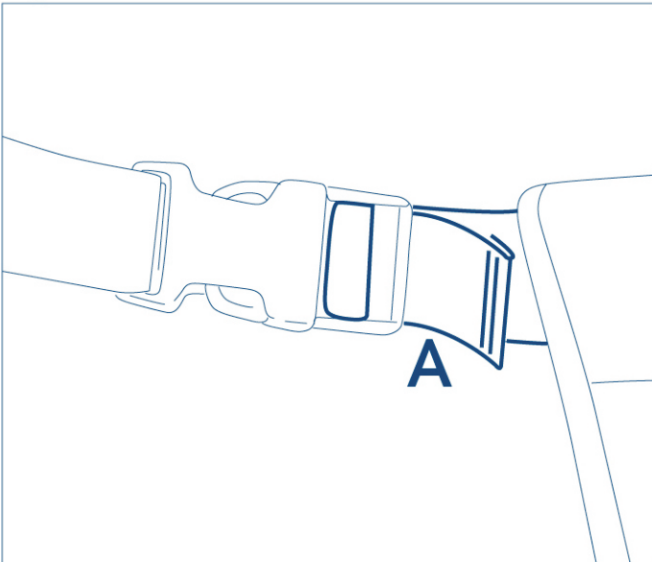

Adjust the waist strap length by pulling on free end 'A' to get a snug fit around your child.

fig 9

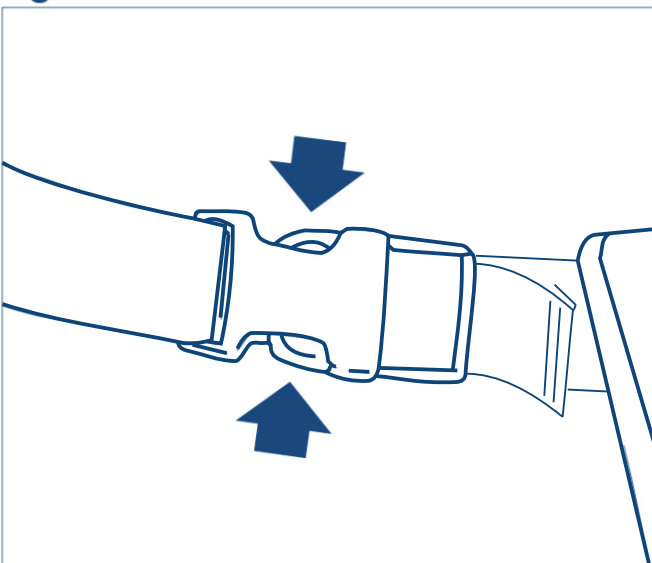

To release the harness, squeeze the buckle prongs together as shown.

using the vibrating unit

fig 10

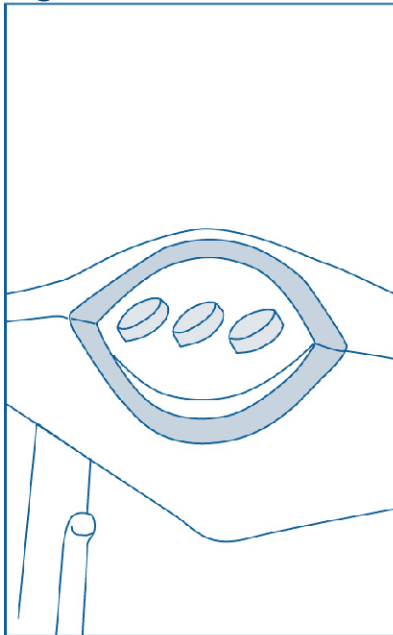

The vibrating unit has three settings: 0, 1 and 2. 0 is off, 1 is a gentle vibration and 2 is a more rapid vibration.

To stop the bouncer vibrating at any time simply press the 0 button.

after use

to fold

fig 11

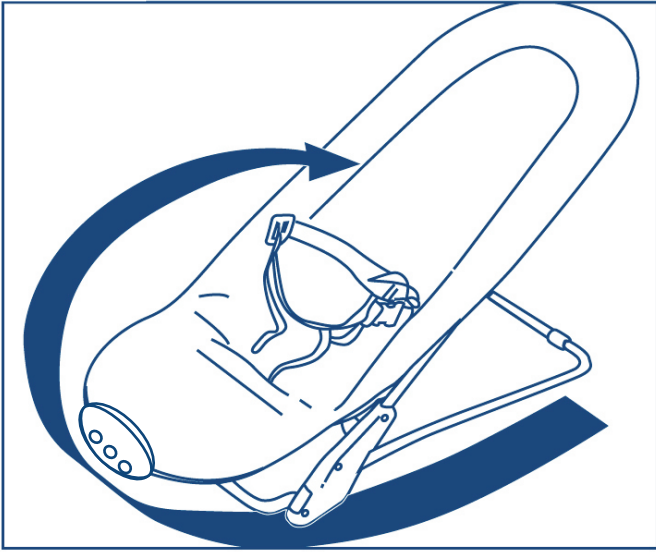

The cradle can be folded for storage. First remove the toy bar, then pull the base around to rest against the seat cover.

fig 12

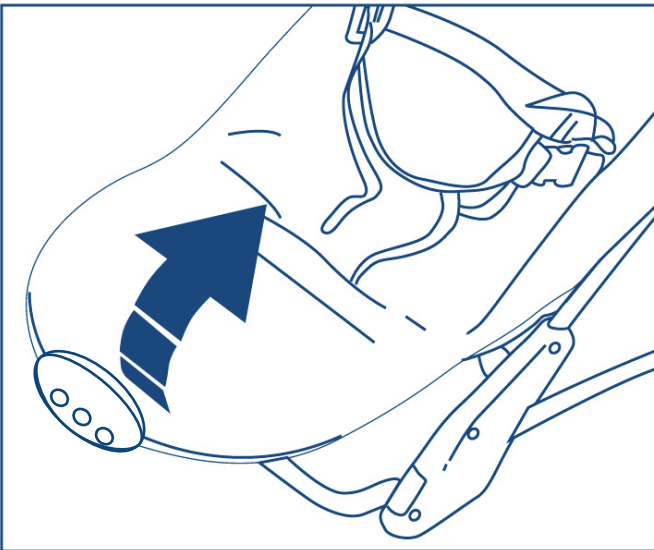

Lift the footrest up against the seat.

care of your product

- The fabric cover can be removed for cleaning.
- Follow the care instructions on the back of the fabric.
- Ensure that all metal parts are removed from cover before washing.
- Ensure the frame is correctly re-assembled before use, by following these instructions.
- Regularly check that the frame remains securely assembled and that the fabric and stitching is undamaged.

safety

- **WARNING** - Never leave the child unattended in the cradle.
- **WARNING** - It is dangerous to put this cradle on an elevated surface, such as a worktop or bed.
- Conforms to BS EN 12790:2002
- Do not use near an open fire or any other kind of heater.
- Keep children away from the cradle during set-up and when not in use.
- Never use as a child restraint in a vehicle.
- Do not attempt to move or lift the cradle when a child is in it.
- Do not use near stairs or steps.
- Always use the restraint system, ensuring it is correctly adjusted at all times.
- Regularly check for loose or damaged parts and discontinue use should parts become damaged or broken.
- Not recommended for children who can sit up by themselves (6 months approximately ; until 9 kg).
- Do not use replacement parts or accessories other than those approved by Mothercare as they may make the cradle unsafe.